

**FILED**  
IN SAN BENITO COUNTY



*Clark*

MAR 08 2017  
JOE PAUL GONZALEZ, COUNTY CLERK  
BY Kristina Tedesco  
DEPUTY CLERK

**SAN BENITO COUNTY PLANNING**  
2301 Technology Parkway, Hollister, CA 95023  
(831) 637-5313

SAN BENITO COUNTY CLERK - RECORDER  
RECEIVED: 3/8/17  
REMOVE: 3/7/17 SCAN: 3/8/17

**PUBLIC NOTICE OF ADMINISTRATIVE REVIEW**

Application:	<u>UP1164-17</u>
Applicant/Owner:	<u>GRANITE ROCK</u>
APN:	<u>011-390-005, -001</u>
Zoning:	<u>HI/ Heavy Industrial</u>
Request:	<u>Solar array to generate on-site power for Quarry</u>

Dear Neighbor and Interested Parties:

This **Notice** is a brief description of a **proposed** project located in your neighborhood. Application materials are available for review at the San Benito County Planning Department, file UP 1164-17.

For more information or to comment on this project, you may write or call **(831) 637-5313** and speak to the Project Planner, Shandell Clark. It is not necessary to be for or against a project to be concerned or to provide important information.

A decision on this request will be made on or after March 28<sup>th</sup>, 2017 unless a written request for a public hearing is received prior to the decision date. A request for a public hearing must be based on a substantive issue and submitted with a public hearing fee.

*A copy of this notice was distributed to the entities identified below on March 7, 2017 by Shandell Clark.*

*Shandell Clark*  
 Clerk      ✓ 300 foot list      ✓ Planning Counter



# ISSUE FOR PERMIT NOT FOR CONSTRUCTION

NO.	DATE	DESCRIPTION
1	03/18/2017	ISSUE FOR PERMIT

GRANITE ROCK QUARRY  
SOLAR PROJECT  
APR 15 11:20 AM 2017  
10000 KATY ROAD  
HOUSTON, TEXAS 77059  
EROSION AND SEDIMENTATION CONTROL PLAN

C-701

### LEGEND

	PROPERTY LINE
	EASEMENT
	UTILITY LINE
	FENCING
	WATER FEATURE
	POWER POLE
	SURVEY POINT
	SPOT ELEVATION
	CONTOUR LINE
	PROPOSED STRUCTURE
	PROPOSED ROAD
	PROPOSED UTILITY
	PROPOSED FENCING
	PROPOSED WATER FEATURE
	PROPOSED POWER POLE
	PROPOSED SURVEY POINT
	PROPOSED SPOT ELEVATION
	PROPOSED CONTOUR LINE

- ### REVISIONS/REMARKS
- ALL CONSTRUCTION SHALL BE IN ACCORDANCE WITH STATE AND LOCAL REQUIREMENTS.
  - SEE EROSION PREVENTION AND SEDIMENTATION CONTROL NOTES ON SHEET C-02.
  - SEE EROSION AND SEDIMENTATION CONTROL DETAILS ON SHEET C-03.
  - SEE GRADING PLAN ON SHEET C-11.
  - MAINTENANCE SUFFICIENT EROSION CONTROL PRACTICES MUST BE INSTALLED AND MAINTAINED TO PREVENT EROSION AND SEDIMENTATION FROM THE SITE. ALL EROSION AND SEDIMENTATION CONTROL PRACTICES SHALL BE INSTALLED AND MAINTAINED THROUGHOUT CONSTRUCTION PERMIT TERM. NECESSARY REPAIRS WILL BE MADE IMMEDIATELY.
  - GRANITE ROCK SHALL PREPARE A SUMMARY OF EROSION AND SEDIMENTATION CONTROL PRACTICES TO BE SUBMITTED TO THE ENGINEER FOR REVIEW AND APPROVAL PRIOR TO THE BEGINNING OF CONSTRUCTION PERMIT.
  - CONTRACTOR SHALL MAINTAIN ALL EROSION AND SEDIMENTATION CONTROL PRACTICES THROUGHOUT CONSTRUCTION PERMIT TERM.
  - ALL EROSION AND SEDIMENTATION CONTROL PRACTICES SHALL BE MAINTAINED THROUGHOUT CONSTRUCTION PERMIT TERM.
  - CONTRACTOR SHALL MAINTAIN ALL EROSION AND SEDIMENTATION CONTROL PRACTICES THROUGHOUT CONSTRUCTION PERMIT TERM.
  - CONTRACTOR SHALL MAINTAIN ALL EROSION AND SEDIMENTATION CONTROL PRACTICES THROUGHOUT CONSTRUCTION PERMIT TERM.
  - CONTRACTOR SHALL MAINTAIN ALL EROSION AND SEDIMENTATION CONTROL PRACTICES THROUGHOUT CONSTRUCTION PERMIT TERM.

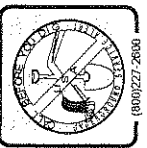
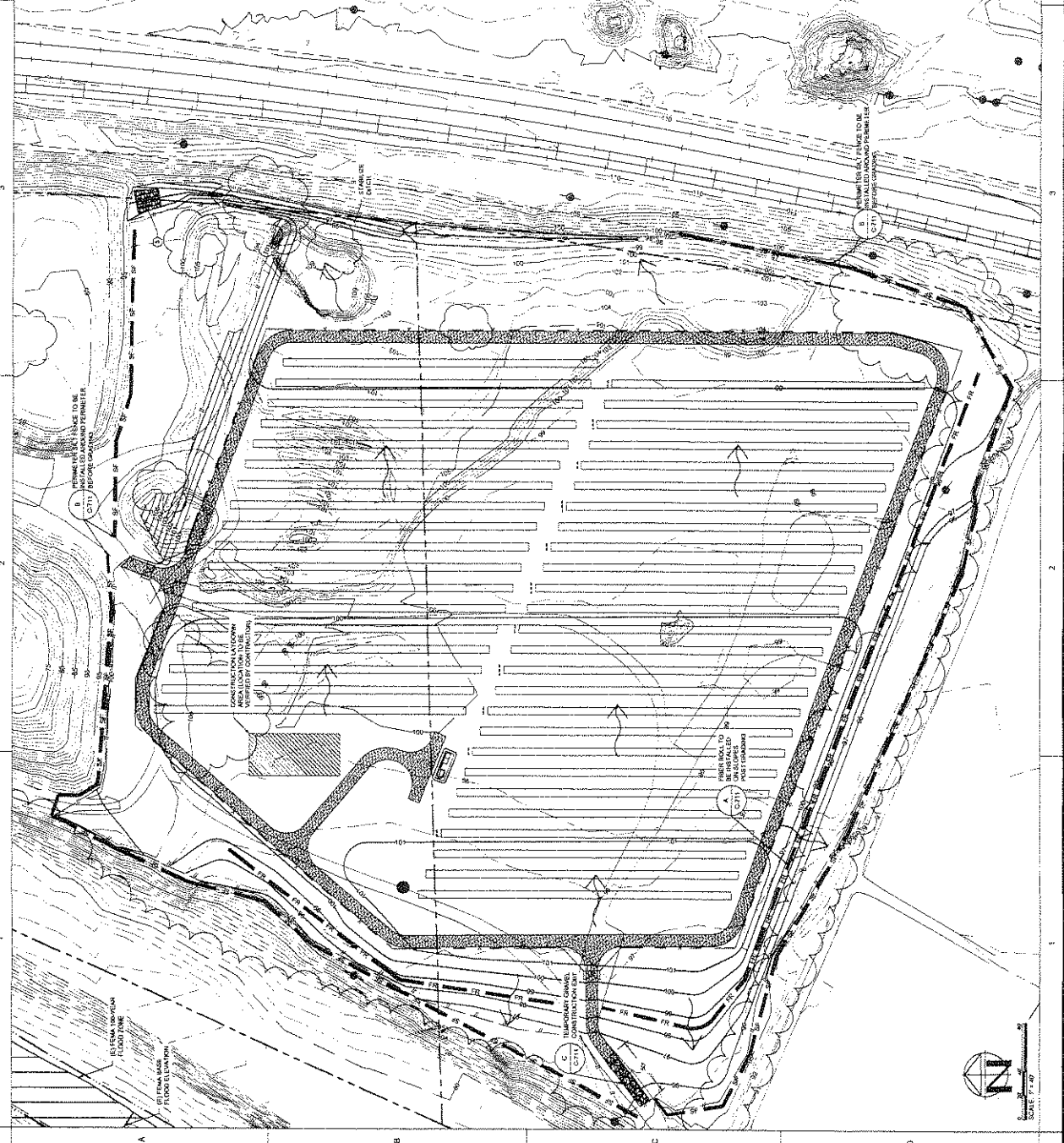

SCALE: 1"=50'